

MS-600 Dumps

Building Applications and Solutions with Microsoft 365 Core Services

<https://www.certleader.com/MS-600-dumps.html>



NEW QUESTION 1

- (Exam Topic 1)

Which URI should you use to query all the emails that relate to an invoice?

`https://graph.microsoft.com/v1.0/me/messages?$search="{invoiceid}"`

`https://graph.microsoft.com/v1.0/me/messages?$subject eq {invoiceid}`

`https://graph.microsoft.com/v1.0/me/messages?${invoiceid}`

`https://graph.microsoft.com/v1.0/me/messages?$filter=contains(subject,{invoiceid})`

- A. Option A
- B. Option B
- C. Option C
- D. Option D

Answer: A

NEW QUESTION 2

- (Exam Topic 1)

You need to implement the role functionality for the backend web service calls.

Which three actions should you perform in sequence? To answer, move the actions from the list of actions to the answer area and arrange them in the correct order.

Actions

- Upload a certificate for the application registration of the backend web service.
- Modify the manifest that defines the application roles and set Allowed Member Types to **Apps**.
- Modify the manifest that defines the application roles and set Allowed Member Types to **Users**.
- Create a new client secret in the application registration of the backend web service.
- Verify for the role claims in the backend web service.
- Assign the roles to the Azure AD group that contains the users who are mapped to the roles.

1

2

3

Answer Area

- A. Mastered
- B. Not Mastered

Answer: A

Explanation:

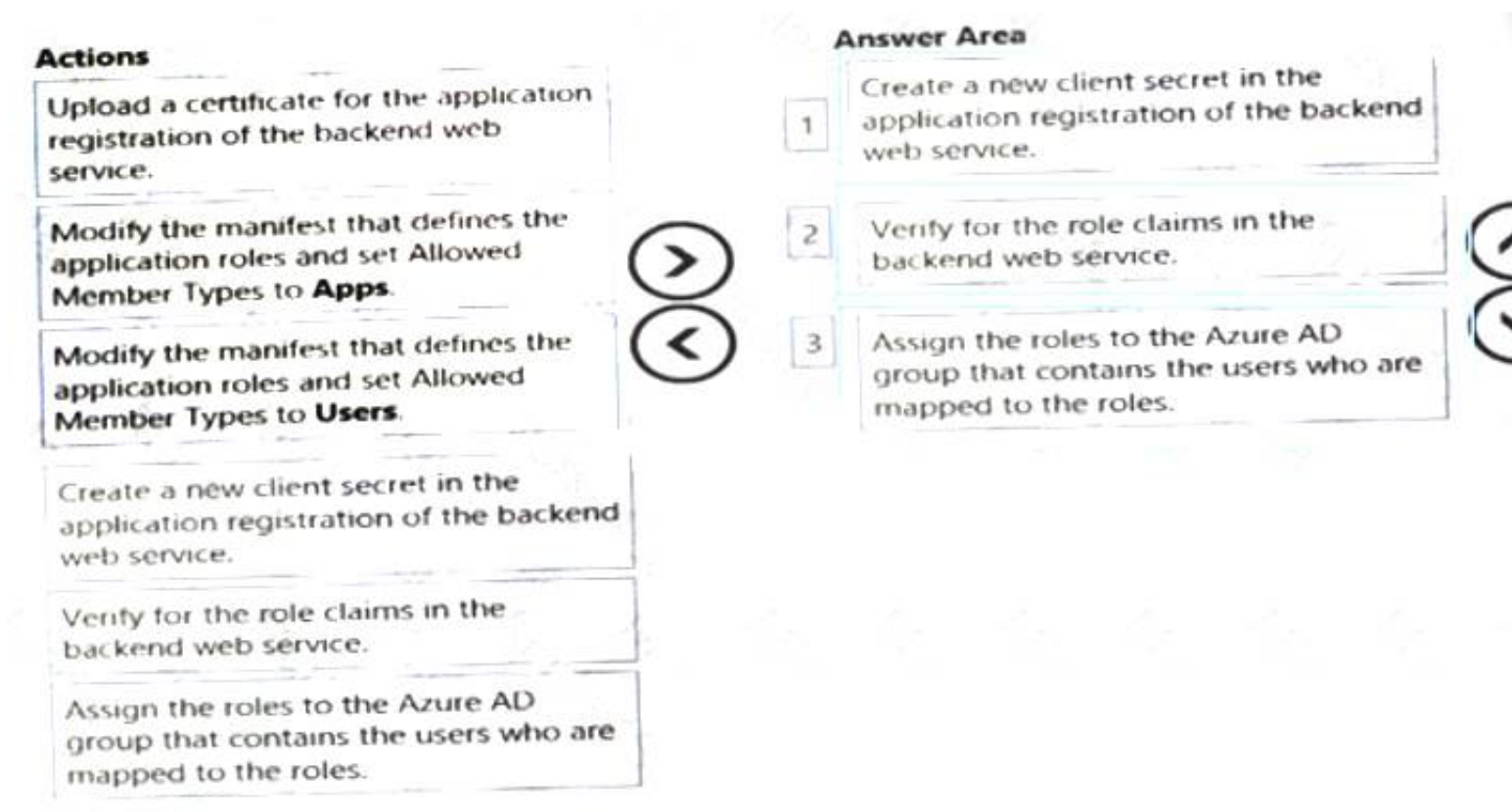

NEW QUESTION 3

- (Exam Topic 1)

You need to complete the MSAL.js code for SSO. Which code segment should you insert at line 06?

- A. storeAuthStateInCookie: false
- B. storeAuthStateInCookie: true
- C. cacheLocation: 'localStorage'
- D. cacheLocation: 'sessionStorage'

Answer: C

Explanation:

Scenario: Implement single sign-on (SSO) and minimize login prompts across browser tabs.

When your application is open in multiple tabs and you first sign in the user on one tab, the user is also signed in on the other tabs without being prompted.

MSAL.js caches the ID token for the user in the browser localStorage and will sign the user in to the application on the other open tabs.

By default, MSAL.js uses sessionStorage which does not allow the session to be shared between tabs. To get SSO between tabs, make sure to set the cacheLocation in MSAL.js to localStorage.

Reference: <https://docs.microsoft.com/bs-latn-ba/Azure/active-directory/develop/msal-js-sso>

NEW QUESTION 4

- (Exam Topic 2)

You are developing a server-based web app that will use OAuth2 on behalf of the user and will be registered with the Microsoft identity platform.

Which two types of token will the app retrieve as part of the authorization flow? Each correct answer presents part of the solution. NOTE: Each correct selection is worth one point.

- A. context token
- B. Kerberos token
- C. refresh token
- D. SAML token
- E. access token

Answer: BD

NEW QUESTION 5

- (Exam Topic 2)

You are developing a Microsoft Office Add-in for Microsoft Word. Which Office UI element can contain commands from the add-in?

- A. dialog boxes
- B. the Quick Access Toolbar (QAT)
- C. context menus
- D. task panes

Answer: A

NEW QUESTION 6

- (Exam Topic 2)

You need to request permission to create a group in a Sharepoint Framework (SPFx) solution. To which file should you add the permission request?

- A. Config.json
- B. Package.json
- C. Serve.json
- D. Package-solution.json

Answer: D

NEW QUESTION 7

- (Exam Topic 2)

You are building a single-page application (SPA) that will have the following parameters:

- App Id: DBA22F72-64PA4C44-AA2C-FAA0DA5A471B
- Tenant Id: DC045C4D-5881-43C7-97AB-3C5A1ADB8DBC
- AppName: Contoso.Spa

You have a line-of-business API for invoicing that is secured by using the Microsoft identity platform. The API has the following parameters:

- * App Id: 8/9A43D7-1794-47A0-AB2B-440B63FEC248
- * Tenant Id: DC04SC4D S881-43C7-97AB 3C5A1ADB8DBC
- * AppName: Contoso.Invoicing

Contoso.Invoicing declares the following custom scopes:

- * Invoices-Read
- * Invoices. Read Write

Contoso.Spa needs to call Contoso.Invoicing to create new invoices.

Which code should you use in Contoso.Spa to obtain an access token for Contoso.Invoicing? To answer, select the appropriate options in the answer area.

NOTE: Each correct select is worth one point.

Answer Area

```
const app = new UserAgentApplication({
  auth: {
    clientId: 'DBA22F72-642A-4C44-AA2C-FAA0DA5A471B',
    clientId: '879A43D7-1794-47A0-AB2B-440B63FEC248',
    clientId: 'DC045C4D-5881-43C7-97AB-3C5A1ADB8DBC',
  },
  authority: 'https://login.microsoftonline.com/DBA22F72-642A-4C44-AA2C-FAA0DA5A471B/',
  authority: 'https://login.microsoftonline.com/879A43D7-1794-47A0-AB2B-440B63FEC248/',
  authority: 'https://login.microsoftonline.com/DC045C4D-5881-43C7-97AB-3C5A1ADB8DBC/',
  system: {
    logger: new Logger(this.logger)
  },
  cache: {cacheLocation: "localStorage"}
});

const response = await app.acquireTokenSilent({
  scopes: ['api://879A43D7-1794-47A0-AB2B-440B63FEC248/Invoices.Read'],
  scopes: ['api://879A43D7-1794-47A0-AB2B-440B63FEC248/Invoices.ReadWrite'],
  scopes: ['api://DBA22F72-642A-4C44-AA2C-FAA0DA5A471B/Invoices.ReadWrite'],
  scopes: ['api://DC045C4D-5881-43C7-97AB-3C5A1ADB8DBC/Invoices.Read'],
  scopes: ['Invoices.Read'],
  scopes: ['Invoices.ReadWrite']
});
```

- A. Mastered
- B. Not Mastered

Answer: A

Explanation:

Answer Area

```
const app = new UserAgentApplication({  
  auth: {  
    clientId: 'DBA22F72-642A-4C44-AA2C-FAA0DA5A471B',  
    clientId: '879A43D7-1794-47A0-AB2B-440B63FEC248',  
    clientId: 'DC045C4D-5881-43C7-97AB-3C5A1ADB8DBC',  
    authority: 'https://login.microsoftonline.com/DBA22F72-642A-4C44-AA2C-FAA0DA5A471B/',  
    authority: 'https://login.microsoftonline.com/879A43D7-1794-47A0-AB2B-440B63FEC248/',  
    authority: 'https://login.microsoftonline.com/DC045C4D-5881-43C7-97AB-3C5A1ADB8DBC/',  
  },  
  system: {  
    logger: new Logger(this.logger)  
  },  
  cache: {cacheLocation: "localStorage"}  
});  
  
const response = await app.acquireTokenSilent({  
  scopes: ['api://879A43D7-1794-47A0-AB2B-440B63FEC248/Invoices.Read'],  
  scopes: ['api://879A43D7-1794-47A0-AB2B-440B63FEC248/Invoices.ReadWrite'],  
  scopes: ['api://DBA22F72-642A-4C44-AA2C-FAA0DA5A471B/Invoices.ReadWrite'],  
  scopes: ['api://DC045C4D-5881-43C7-97AB-3C5A1ADB8DBC/Invoices.Read'],  
  scopes: ['Invoices.Read'],  
  scopes: ['Invoices.ReadWrite']  
});
```

NEW QUESTION 8

- (Exam Topic 2)

You have an API that is secured by using Azure Active Directory (Azure AD). You are designing a SharePoint Framework (SPFx) solution. Which object should you use to connect to the API from the solution?

- A. SPHttpClient
- B. HttpClient
- C. AadHttpClient

Answer: C

Explanation:

By using the AadHttpClient, you can easily connect to APIs secured by using Azure AD without having to implement the OAuth flow yourself. Reference: <https://docs.microsoft.com/en-us/sharepoint/dev/spfx/use-aadhttpclient>

NEW QUESTION 9

- (Exam Topic 2)

You have an application named App1 that is used to administer an Azure Active Directory (Azure AD) tenant. When administrators install App1, they are prompted for admin consent.

Which application permission can cause the administrators to be prompted for consent?

- A. RoleManagement
- B. Read . Directory
- C. Device.Command
- D. Device.Read
- E. Calendars.ReadWrite

Answer: A

NEW QUESTION 10

- (Exam Topic 2)

You need to develop a client-side web app that will be registered with the Microsoft identity platform. Which type of authorization flow should you use?

- A. authorization code grant
- B. device code grant
- C. implicit grant
- D. client credentials grant

Answer: A

NEW QUESTION 10

- (Exam Topic 2)

You have an application that uses the Microsoft graph API.

When users open the application during peak hours, they occasionally receive an HTTP 429 Too Many requests response status code.

What should you do to mitigate the errors?

- A. Adjust the request rate based on the Rate-Limit-Reset Header.

- B. Wait 100 milliseconds between requests.
C. Adjust the request rate based on the Retry-After header.

Answer: C

NEW QUESTION 14

- (Exam Topic 2)

For each of the following statements, select Yes if the statement is true. Otherwise, select No.

NOTE: Each correct selection is worth one point.

Statements	Yes	No
A Microsoft Office Add-in manifest must be stored in Azure Directory (Azure AD).	<input type="radio"/>	<input type="radio"/>
A Microsoft Office Add-in manifest must be in the JSON format.	<input type="radio"/>	<input type="radio"/>
A Microsoft Office Add-in manifest must contain a URI that points to the location that hosts the add-in.	<input type="radio"/>	<input type="radio"/>

- A. Mastered
B. Not Mastered

Answer: A

Explanation:

Box 1: No

Box 2: No

The manifest is in XML format.

Box 3: Yes

SourceLocation is required and specifies the source file location(s) for your Office Add-in as a URL between 1 and 2018 characters long. The source location must be an HTTPS address, not a file path.

References: <https://docs.microsoft.com/en-us/office/dev/add-ins/develop/add-in-manifests> <https://docs.microsoft.com/en-us/office/dev/add-ins/reference/manifest/sourcelocation>

NEW QUESTION 16

- (Exam Topic 2)

You are developing a front end web app.

You want to display the current username as part of the user interface.

You need to retrieve the current username from Microsoft Graph by using a REST request. The solution must minimize the amount of information returned.

To which URI should you send the request?

☐
[https://graph.microsoft.com/v1.0/users/john@contoso.com/people?\\$select=displayName](https://graph.microsoft.com/v1.0/users/john@contoso.com/people?$select=displayName)

☐
[https://graph.microsoft.com/v1.0/me?\\$search=displayName](https://graph.microsoft.com/v1.0/me?$search=displayName)

☐
<https://graph.microsoft.com/v1.0/me>

☐
[https://graph.microsoft.com/v1.0/me?\\$select=displayName](https://graph.microsoft.com/v1.0/me?$select=displayName)

- A. Option A
B. Option B
C. Option C
D. Option D

Answer: A

NEW QUESTION 20

- (Exam Topic 2)

You company has a third-party invoicing web app.

You need to display the app within Microsoft Teams for one user only. The app will not require conversational interactions.

How should you display the app by using the minimum amount of effort?

- A. Instruct the user to add a website tab
B. Instruct the user to add an App Studio app
C. Create a SharePoint Framework (SPFx) web part
D. Create a search-based messaging extension

Answer: A

Explanation:

There are currently three methods of app integration in Teams: Connectors, Bots, and Tabs. Tabs offer more extensive integration by allowing you to view entire third-party services within Microsoft Teams. Reference: <https://www.sherweb.com/blog/office-365/o365-microsoft-teams-apps/>

NEW QUESTION 23

- (Exam Topic 2)

For each of the following statements, select Yes if the statement is true. Otherwise, select No.

NOTE: Each correct selection is worth one point.

Statements	Yes	No
You can use the JavaScript API for Microsoft Office to create a tab in Microsoft Teams.	<input type="radio"/>	<input type="radio"/>
You can use the JavaScript API for Microsoft Office to create a content add-in in Microsoft Excel.	<input type="radio"/>	<input type="radio"/>
You can use the JavaScript API for Microsoft Office to create a task pane add-in in Microsoft PowerPoint.	<input type="radio"/>	<input type="radio"/>

- A. Mastered
- B. Not Mastered

Answer: A

Explanation:

Box 1: Yes

As part of your app you can add custom tabs to embed your own web content in Teams, and using the Teams JavaScript client SDK, add Teams-specific functionality to your web content.

Box 2: Yes

You can use the Office JavaScript API to create task pane or content add-ins for Office 2013 host applications. Box 3: Yes

You can use the Office JavaScript API to create task pane or content add-ins for Office 2013 host applications. Reference: <https://docs.microsoft.com/en-us/microsoftteams/platform/tabs/what-are-tabs> <https://docs.microsoft.com/en-us/office/dev/add-ins/develop/support-for-task-pane-and-content-add-ins>

NEW QUESTION 25

- (Exam Topic 2)

You use Azure Active Directory (Azure AD) to store user identities. The user profile information is inconsistently populated.

You need to develop a web app that will provide users with a page where they can enter their interests, skill, and description. When the user click the submit button, the app will use Microsoft graph to send the data to Azure AD.

Which HTTP method should you use against the Microsoft graph endpoint?

- A. PUT
- B. POST
- C. PATCH
- D. GET

Answer: A

NEW QUESTION 29

- (Exam Topic 2)

Note: This question is part of a series of questions that present the same scenario. Each question in the series contains a unique solution that might meet the stated goals. Some question sets have more than one correct solution, while others might not have a correct solution.

After you answer a question in this section, you will NOT be able to return to it. As a result, these questions will not appear in the review screen.

You are developing a new application named App1 that uses the Microsoft identity platform to authenticate to Azure Active Directory (Azure AD).

Currently, App1 can read user profile information. You need to allow App1 to read the user's calendar.

Solution: In the code of App1, dynamically request the Calendar.Read permission from the Microsoft Graph API.

Does this meet the goal?

- A. Yes
- B. No

Answer: B

Explanation:

For your app to access data in Microsoft Graph, the user or administrator must grant it the correct permissions via a consent process.

Application permissions can only be consented by an administrator.

References: <https://docs.microsoft.com/en-us/azure/active-directory/develop/v2-permissions-and-consent> <https://docs.microsoft.com/en-us/graph/permissions-reference>

NEW QUESTION 33

- (Exam Topic 2)

This question requires that you evaluate the bold text to determine if it is correct.

You can use a Command Set extension to develop a breadcrumb element that will appear on every Microsoft SharePoint page.

Instructions: Review the underlined text. If it makes the statement correct, select “No change is needed”. If the statement is incorrect, select the answer choice that makes the statement correct.

- A. No change is needed
- B. an Application Customizer
- C. a Field Customizer
- D. a web part

Answer: B

Explanation:

Application Customizers provide access to well-known locations on SharePoint pages that you can modify based on your business and functional requirements. For example, you can create dynamic header and footer experiences that render across all the pages in SharePoint Online.

Reference:

<https://docs.microsoft.com/en-us/sharepoint/dev/spfx/extensions/get-started/using-page-placeholder-with-extens>

NEW QUESTION 35

- (Exam Topic 2)

You have a SharePoint Framework (SPFx) web part that displays the weather. Users can set the city within the web part. Which component is invoked to provide the users with the ability to configure the settings for the web part?

- A. a custom control
- B. the property pane
- C. the Application Customizer
- D. a library component

Answer: B

NEW QUESTION 39

- (Exam Topic 2)

You have an application that has the code shown in the exhibits. (Click the JavaScript Version tab or the C# Version tab.)

For each of the following statements, select Yes if the statement is true. Otherwise, select No. NOTE: Each correct selection is worth one point.

JavaScript Version

```
module.exports = function(context, myTrigger) {
    //...
    var group = {
        DisplayName: groupTitle,
        GroupTypes: ["Unified"],
        MailEnabled: true,
        SecurityEnabled: false,
        Visibility: "Private"
    };
    client.api('/groups').post(group).then((groupResult) => {
        client.api('/users/${userName}').get().then((userResult) => {
            var user = {
                "@odata.id": 'https://graph.microsoft.com/v1.0/directoryObjects/${UserResult.Id}'
            };
            client.api('/groups/${groupResult.Id}/members/${ref}').post(user).then(() => {
                context.done();
            });
        });
    });
};
```

C# Version

```
namespace MyProject
{
    public static class MainActivity
    {
        [FunctionName(nameof(MainActivity))]
        public static async Task Run([ActivityTrigger] string accessToken, string userEmail, string groupTitle)
        {
            var client = new GraphServiceClient(new GraphAuthProvider(accessToken));
            var group = new Group
            {
                DisplayName = groupTitle,
                GroupTypes = new string[] { "Unified" },
                MailEnabled = true,
                SecurityEnabled = false,
                Visibility = "Private"
            };
            var createdGroup = await client.Groups.Request().AddAsync(group);
            var user = await client.Users[userEmail].Request().GetAsync();
            await client.Groups[createdGroup.Id].Members.References.Request().AddAsync(user);
        }
    }
}
```

Statements	Yes	No
The code creates a unified group in Microsoft Office 365.	<input type="radio"/>	<input type="radio"/>
The code adds a member to a group.	<input type="radio"/>	<input type="radio"/>
The code adds an owner to a group.	<input type="radio"/>	<input type="radio"/>
The code creates a team in Microsoft Teams.	<input type="radio"/>	<input type="radio"/>

- A. Mastered
B. Not Mastered

Answer: A

Explanation:

Box 1: Yes

Unified is specified in the code.

Note: You can create the following types of groups: Office 365 group (unified group)

Security group Box 2: Yes

A member is added to the group. Box 3: No

Box 4: No

Reference: <https://docs.microsoft.com/en-us/graph/api/group-post-groups>

NEW QUESTION 40

- (Exam Topic 2)

You are developing a mobile application that will display the current signed-in user's display name and the application settings. The application settings are stored as Microsoft graph extension of the user profile.

Users of the application have intermittent network connectivity.

You need to retrieve the least amount of data by using a single REST request. The solution must minimize network traffic.

Which URI Should you use to retrieve the data?

`https://graph.microsoft.com/v1.0/me?$select=displayName,userType&$expand=extensions`

`https://graph.microsoft.com/v1.0/me?$select=displayName,id&$expand=extensions`

`https://graph.microsoft.com/v1.0/me`

`https://graph.microsoft.com/v1.0/me?$expand=extensions`

- A. Option A
B. Option B
C. Option C
D. Option D

Answer: C

NEW QUESTION 43

- (Exam Topic 2)

Note: This question is part of a series of questions that present the same scenario. Each question in the series contains a unique solution that might meet the stated goals. Some question sets have more than one correct solution, while others might not have a correct solution.

After you answer a question in this section, you will NOT be able to return to it. As a result, these questions will not appear in the review screen.

You are developing a new application named App1 that uses the Microsoft identity platform to authenticate to Azure Active Directory (Azure AD).

Currently, App1 can read user profile information. You need to allow App1 to read the user's calendar.

Solution: From the Azure portal, add the Microsoft Graph API and the Calendar.Read permission by using the API permission list of App1. Grant tenant admin consent.

Does this meet the goal?

- A. Yes
B. No

Answer: A

Explanation:

Microsoft Graph Calendars.Read allows the app to read events in user calendars.

For your app to access data in Microsoft Graph, the user or administrator must grant it the correct permissions via a consent process.

Application permissions are used by apps that run without a signed-in user present; for example, apps that run as background services or daemons. Application permissions can only be consented by an administrator.

References: <https://docs.microsoft.com/en-us/azure/active-directory/develop/v2-permissions-and-consent> <https://docs.microsoft.com/en-us/graph/permissions-reference>

NEW QUESTION 47

- (Exam Topic 2)

You plan to create a Microsoft Teams application that uses action-based messaging extensions. For each of the following statements, select Yes if the statement is true. Otherwise, select No. NOTE: Each correct selection is worth one point.

Answer Area	Statements	Yes	No
	A Teams application can have multiple action-based messaging extensions.	<input type="radio"/>	<input type="radio"/>
	Action-based messaging extensions can contain unlimited commands.	<input type="radio"/>	<input type="radio"/>
	Action-based messaging extensions can use the Bot Framework to collect information from users.	<input type="radio"/>	<input type="radio"/>

- A. Mastered
- B. Not Mastered

Answer: A

Explanation:

Answer Area	Statements	Yes	No
	A Teams application can have multiple action-based messaging extensions.	<input type="radio"/>	<input checked="" type="radio"/>
	Action-based messaging extensions can contain unlimited commands.	<input type="radio"/>	<input checked="" type="radio"/>
	Action-based messaging extensions can use the Bot Framework to collect information from users.	<input checked="" type="radio"/>	<input type="radio"/>

NEW QUESTION 52

- (Exam Topic 2)

You are developing an Azure function to provision a team in Microsoft Teams.

You need to create a group named Project A, add a classification of Private to the group, and then convert Project A to a team group.

How should you complete the REST requests? To answer, select the appropriate options in the answer area. NOTE: Each correct selection is worth one point.

Request 1:

▼

https://graph.microsoft.com/v1.0/groups

GET

PATCH

POST

PUT

```
{
  "description": "",
  "displayName": "Project A",
  "groupTypes": ["Unified"],
  "mailEnabled": true,
  "mailNickname": "projecta",
  "securityEnabled": "projecta",
  "securityEnabled": false
}
```

Request 2:

▼

https://graph.microsoft.com/v1.0/groups/{GroupID}

GET

PATCH

POST

PUT

```
{
  "classification": "Private"
}
```

Request 3:

▼

https://graph.microsoft.com/v1.0/groups/{GroupID}/team

GET

PATCH

POST

PUT

```
{
  "memberSettings": {
    "allowCreateUpdateChannels": true
  }
}
```

- A. Mastered
B. Not Mastered

Answer: A

Explanation:

Box 1: post

You need to create a group named Project A.

The following example creates an Office 365 group. POST https://graph.microsoft.com/v1.0/groups Content-type: application/json

Content-length: 244

```
{
  "description": "Self help community for library", "displayName": "Library Assist",
  "groupTypes": [ "Unified"
],
  "mailEnabled": true, "mailNickname": "library", "securityEnabled": false
}
```

Box 2: PATCH

Add a classification of Private to the group.

You can set the classification property in a PATCH request for the group, if do not set it in the initial POST request that creates the group.

Box 3: put

Then convert Project A to a team group. Syntax: PUT /groups/{id}/team

References: <https://docs.microsoft.com/en-us/graph/api/group-post-groups> <https://docs.microsoft.com/en-us/graph/api/resources/group>

<https://docs.microsoft.com/en-us/graph/api/team-put-teams>

NEW QUESTION 55

- (Exam Topic 2)

You are developing an application that will upload files that are larger than 50 MB to Microsoft OneDrive.

You need to recommend an upload solution to ensure that the file upload process can resume if a network error occurs during the upload.

Which four actions should you perform in sequence? To answer, move the actions from the list of actions to the answer area and arrange them in the correct order.



- A. Mastered
- B. Not Mastered

Answer: A

Explanation:

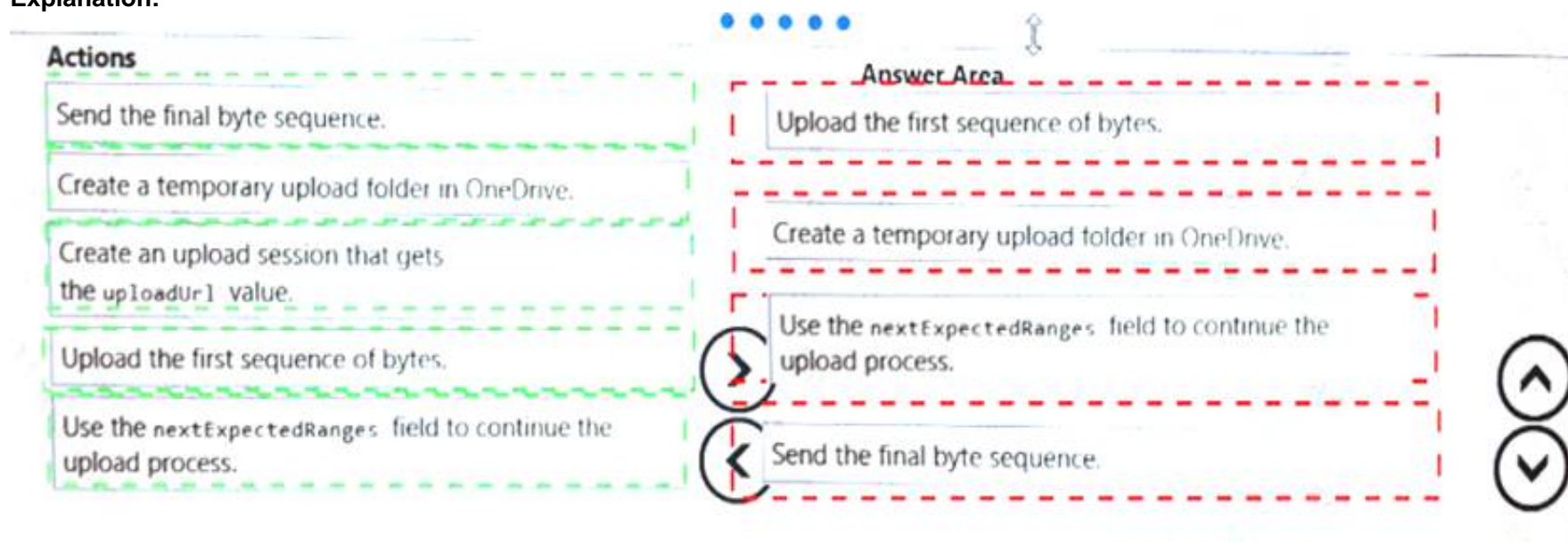

NEW QUESTION 58

- (Exam Topic 2)

You are building email notifications for an expensing system.

When a user receives an email notification, the email will contain a comment field. When the user submits a comment, the data will be returned to the expensing system for processing.

What should you do to implement the notification by using the minimum amount of development effort?

- A. Create a Microsoft Office Add-in that has an action pane to display the notifications
- B. Leverage Microsoft Graph notifications
- C. Leverage the Azure SignalR Service and implement web notifications
- D. Configure the expensing system to send actionable messages

Answer: D

Explanation:

Whether you are filling out a survey, approving an expense report, or updating a CRM sales opportunity, Actionable Messages enable you to take quick actions right from within Outlook. Developers can now embed actions in their emails or notifications, elevating user engagement with their services and increasing organizational productivity.

Office 365 provides two solutions to enhance productivity with Outlook Actionable Messages: actionable messages via email, and actionable messages via Office 365 Connectors.

Reference: <https://docs.microsoft.com/en-us/outlook/actionable-messages/>

NEW QUESTION 61

- (Exam Topic 2)

You develop a web API named WebApi1.

When validating a token received from a client application, WebApi1 receives a `MsalUiRequiredException` exception from Azure Active Directory (Azure AD).

You need to formulate the response that WebApi1 will return to the client application. Which HTTP response should you send?

- A. HTTP 307 Temporary Redirect
- B. HTTP 400 Bad Request
- C. HTTP 403 Forbidden
- D. HTTP 412 Precondition Failed

Answer: D

Explanation:

The HyperText Transfer Protocol (HTTP) 412 Precondition Failed client error response code indicates that access to the target resource has been denied. This happens with conditional requests on methods other than GET or HEAD when the condition defined by the If-Unmodified-Since or If-None-Match headers is not fulfilled. In that case, the request, usually an upload or a modification of a resource, cannot be made and this error response is sent back.

MsalUiRequiredException

The "Ui Required" is proposed as a specialization of MsalServiceException named MsalUiRequiredException. This means you have attempted to use a non-interactive method of acquiring a token (e.g. AcquireTokenSilent), but MSAL could not do it silently. this can be because:

- you need to sign-in
- you need to consent
- you need to go through a multi-factor authentication experience.

The remediation is to call AcquireTokenInteractive try

```
{
app.AcquireTokenXXX(scopes, account) WithYYYY(...)
ExecuteAsync()
}
catch(MsalUiRequiredException ex)
{
app.AcquireTokenInteractive(scopes) WithAccount(account)
WithClaims(ex.Claims) ExcecuteAsync();
}
```

NEW QUESTION 63

- (Exam Topic 2)

For each of the following statements, select Yes if the statement is true. Otherwise, select No.

NOTE: Each correct selection is worth one point.

Statements	Yes	No
You can use the Adaptive Cards Designer to create Microsoft Outlook actionable messages.	<input type="radio"/>	<input type="radio"/>
Microsoft Outlook actionable messages are written in JSON.	<input type="radio"/>	<input type="radio"/>
You need Azure Active Directory (Azure AD) tenant admin privileges to enable Microsoft Outlook actionable messages.	<input type="radio"/>	<input type="radio"/>

A. Mastered

B. Not Mastered

Answer: A

Explanation:

Box 1: Yes

The Adaptive Cards Designer provides a drag-and-drop experience to quickly build and tweak adaptive cards. Outlook Actionable Messages cards are designed using the Adaptive Card format. The Adaptive Card format

is a simple yet powerful declarative layout format that provides a lot of flexibility, allowing for visually rich cards. In this topic we'll cover the Outlook-specific features of the Adaptive Card format.

Box 2: Yes

The actionable message card is in JSON format. Box 3: No

By default, the Tenant Administrator can create, edit, clone, and delete tenants, and manage user accounts. Note:

To enable Actionable Messages the recipient of the task must be an Office 365 customer with permissions for the SharePoint online site.

No: Office 365 administrators can disable actionable messages via the Set-OrganizationConfig cmdlet. If actionable messages do not render, check with your administrator to make sure the feature is enabled in your organization.

Adaptive Cards Designer Microsoft outlook actionable messages

References: <https://docs.microsoft.com/en-us/outlook/actionable-messages/adaptive-card> <https://gingkoapp.com/create-tenant-administrator.html>

NEW QUESTION 65

- (Exam Topic 2)

You are developing a new Microsoft Office Add-in to integrate a corporate invoicing system and Microsoft Excel.

You need to add a new button to the Office ribbon. What should you add to the add-in?

- A. a task pane
- B. a dialog
- C. a custom function
- D. a command

Answer: D

Explanation:

Add commands to a custom group

* 1. In the Customize the Ribbon window under the Customize the Ribbon list, click the custom group that you want to add a command to.

* 2. In the Choose commands from list, click the list you want to add commands from, for example, Popular Commands or All Commands.



* 3. Click a command in the list that you choose.

* 4. Click Add.

* 5. To see and save your changes, click OK. Reference:

<https://support.office.com/en-us/article/customize-the-ribbon-in-office-00f24ca7-6021-48d3-9514-a31a460ecb3>

NEW QUESTION 68

- (Exam Topic 2)

This question requires that you evaluate the underlined text to determine if it is correct.

Centralized deployments for Microsoft Office Add-ins require Office Online Server.

Instructions: Review the underlined text. If it makes the statement correct, select “No change is needed”. If the statement is incorrect, select the answer choice that makes the statement correct.

- A. No change is needed
- B. Azure Active Directory (Azure AD)
- C. Azure AD Connect
- D. an Azure web app

Answer: A

Explanation:

Centralized deployment of add-ins requires that the users are using Office 365 ProPlus (and are signed into Office using their Organizational ID), and have Exchange Online and active Exchange Online mailboxes.

Reference: <https://docs.microsoft.com/en-us/office365/admin/manage/centralized-deployment-of-add-ins>

NEW QUESTION 73

- (Exam Topic 2)

This question requires that you evaluate the underlined text to determine if it is correct.

In Microsoft Word on Windows, before you can sideload a Microsoft Office Add-in, you must first upload the manifest to Microsoft_pnePrivc.

Instructions: Review the underlined text. If it makes the statement correct, select "No change is needed." If the statement is incorrect, select the answer choice that makes the statement correct.

- A. No change is needed.
- B. deploy the manifest to an Azure website
- C. publish the manifest to a trusted network location
- D. set Microsoft Edge to Developer Mode

Answer: A

NEW QUESTION 76

- (Exam Topic 2)

For each of the following statements, select Yes if the statement is true. Otherwise, select NO. NOTE: Each correct selection is worth one point.

Answer Area

Statements	Yes	No
Search-based messaging extensions can query a third-party service and show the information on a card.	<input type="radio"/>	<input type="radio"/>
Search-based messaging extensions can use the Bot Framework to interact with third-party applications.	<input type="radio"/>	<input type="radio"/>
Search-based messaging extensions can be used to display information on a tab.	<input type="radio"/>	<input type="radio"/>

- A. Mastered
- B. Not Mastered

Answer: A

Explanation:

Answer Area

Statements	Yes	No
Search-based messaging extensions can query a third-party service and show the information on a card.	<input type="radio"/>	<input checked="" type="radio"/>
Search-based messaging extensions can use the Bot Framework to interact with third-party applications.	<input type="radio"/>	<input checked="" type="radio"/>
Search-based messaging extensions can be used to display information on a tab.	<input checked="" type="radio"/>	<input type="radio"/>

NEW QUESTION 79

- (Exam Topic 2)

You are developing a SharePoint Framework (SPFx) web part. The web part will call a backed API that is secured by using Azure Active Directory (Azure AD). The web part will be on a page that has many other web parts.

Which type of web part should you use ensure that access to the exclusive to the web part?

- A. Provider-hosted
- B. SharePoint-hosted
- C. Domain isolated
- D. Connected

Answer: A

NEW QUESTION 81

- (Exam Topic 2)

You are developing a Microsoft Teams solution to host an existing webpage as a Teams tab. Which requirement must the page meet?

- A. The page must adhere to HTML 5.0 standards
- B. The page must adhere to WCAG 2.0 accessibility guidelines
- C. The page must be hosted on a domain that is on the validDomains list of the manifest
- D. The page must use CSS3 stylesheets

Answer: C

Explanation:

Make sure that all domains used in your tab pages are listed in the manifest.json validDomains array. Reference: <https://docs.microsoft.com/en-us/microsoftteams/platform/tabs/how-to/create-tab-pages/configuration-page>

NEW QUESTION 84

- (Exam Topic 2)

For each of the following statements, select Yes if the statement is true. Otherwise, select No. NOTE: Each correct select is worth one point.

Answer Area

Statements	Yes	No
A Microsoft Office Web Add-in can be scaffolded by using a Yeoman generator.	<input type="radio"/>	<input type="radio"/>
Microsoft Office Web Add-ins can be developed by using C#.	<input type="radio"/>	<input type="radio"/>
The code for a Microsoft Office Web Add-in has access to the local file system of a device.	<input type="radio"/>	<input type="radio"/>

- A. Mastered
- B. Not Mastered

Answer: A

Explanation:

Answer Area

Statements	Yes	No
A Microsoft Office Web Add-in can be scaffolded by using a Yeoman generator.	<input checked="" type="radio"/>	<input type="radio"/>
Microsoft Office Web Add-ins can be developed by using C#.	<input checked="" type="radio"/>	<input type="radio"/>
The code for a Microsoft Office Web Add-in has access to the local file system of a device.	<input checked="" type="radio"/>	<input type="radio"/>

NEW QUESTION 89

- (Exam Topic 2)

You are building a Microsoft Outlook add-in.

Which object should you use to save additional information in an email?

- A. CustomProperties
- B. CustomXMLParts
- C. RoamingSettings
- D. localStorage

Answer: B

NEW QUESTION 91

- (Exam Topic 2)

You have a single-page application (SPA) named TodoListSPA and a server-based web app named TodoListService.

The permissions for the TodoList SPA API are configured as shown in the TodoList SPA exhibit. (Click the TodoListSPA tab.)

API/PERMISSIONS NAME	TYPE	DESCRIPTION	ADMIN CONSENT REQUIRED
▼ TodoListService-OBO-sample-v2 (1)			
user_impersonation	Delegated	Access TodoListService-OBO-sample-v2	

The permissions for the TodoListService API are configured as shown in the TodoListService exhibit. (Click the TodoListService tab.)

API/PERMISSIONS NAME	TYPE	DESCRIPTION
▼ Microsoft Graph (1)		
UserRead	Delegated	Sign in and read user profile

You need to ensure that TodoListService can access a Microsoft OneDrive file of the signed-in user. The solution must use the principle of least privilege. Which permission should to grant?

- A. the Sites.Read.All delegated permission for TodoListService
- B. the Sites.Read.All delegated permission for TodoListSpa
- C. the Sites.Read.All application permission for TodoListSPA
- D. the Sites.Read.All application permission for TodoListService

Answer: A

Explanation:

A client application gains access to a resource server by declaring permission requests. Two types are available:

"Delegated" permissions, which specify scope-based access using delegated authorization from the signed-in resource owner, are presented to the resource at run-time as "scp" claims in the client's access token.

"Application" permissions, which specify role-based access using the client application's credentials/identity, are presented to the resource at run-time as "roles" claims in the client's access token.

Reference: <https://docs.microsoft.com/en-us/azure/active-directory/develop/developer-glossary#permissions>

NEW QUESTION 93

- (Exam Topic 2)

You are developing a web app that will display emails from the Microsoft 365 mailbox of the current signed-in user.

For performance reasons, you do not want all the emails to be loaded simultaneously, rather page-by-page as the user navigates the app.

You plan to display 30 emails per page. The most recent emails must be displayed first.

How should you complete the query parameters for the REST request to display the third page of emails? To answer, drag the appropriate query parameters to the correct targets. Each query parameter may be used once, more than once, or not at all. You may need to drag the split bar between panes or scroll to view content.

NOTE: Each correct selection is worth one point.

Actions

filter

search

select

skip

top

Answer Area

GET https://graph.microsoft.com/v1.0/me/messages?\$

Parameter

=60&\$

Parameter

=30&\$orderby=sentDateTime desc

- A. Mastered
B. Not Mastered

Answer: A

Explanation:

Box 1: top
Number of items to return in a result Box 2: skip
\$skip Indexes into a result set. Also used by some APIs to implement paging and can be used together with
\$top to manually page results.
Reference: https://developer.microsoft.com/en-us/graph/docs/overview/query_parameters

NEW QUESTION 96

- (Exam Topic 2)
You need to retrieve a list of the last 10 files that the current user opened from Microsoft OneDrive. The response must contain only the file ID and the file name.
Which URI should you use to retrieve the results? To answer, select the appropriate options in the answer area.
NOTE: Each correct selection is worth one point.

https://graph.microsoft.com/v1.0/me/drive /

▼

children

files

recent

root

?

▼

\$expand=id,name

\$select=id,name

\$filter=id,name

&\$top=10

- A. Mastered
B. Not Mastered

Answer: A

Explanation:

"graph.microsoft.com" "drive" onedrive Box 1: root
/root - The root folder for the drive. Box 2: \$select=id,name
To specify a different set of properties to return than the default set provided by the Graph, use the \$select query option. The \$select option allows for choosing a subset or superset of the default set returned. For example, when retrieving your messages, you might want to select that only the from and subject properties of messages are returned.
References: <https://docs.microsoft.com/en-us/onedrive/developer/rest-api/concepts/addressing-driveitems> https://developer.microsoft.com/en-us/graph/docs/overview/query_parameters

NEW QUESTION 100

.....

Thank You for Trying Our Product

* 100% Pass or Money Back

All our products come with a 90-day Money Back Guarantee.

* One year free update

You can enjoy free update one year. 24x7 online support.

* Trusted by Millions

We currently serve more than 30,000,000 customers.

* Shop Securely

All transactions are protected by VeriSign!

100% Pass Your MS-600 Exam with Our Prep Materials Via below:

<https://www.certleader.com/MS-600-dumps.html>