

AB-730 Dumps

AI Business Professional

<https://www.certleader.com/AB-730-dumps.html>



NEW QUESTION 1

You ask Microsoft 365 Copilot to create a report based on information from the web. You verify the response and discover that some information is fictional. What is this an example of?

- A. deepfake
- B. fabrication
- C. overreliance
- D. prompt injection
- E. bias

Answer: B

Explanation:

This scenario is an example of fabrication, which is commonly referred to in generative AI contexts as a hallucination. Fabrication occurs when an AI system generates information that appears credible but is factually incorrect, invented, or unsupported by verifiable sources. According to Microsoft AI Business Professional guidance, large language models predict text based on patterns learned during training. They do not know facts in the human sense. As a result, when asked to generate reports using web-based information, the model may produce plausible-sounding but fictional details if sufficient grounding or reliable sources are not provided. Deepfake refers specifically to synthetic media such as manipulated images, audio, or video. Overreliance describes a human behavior risk where users trust AI outputs without verification. Prompt injection is a malicious technique designed to manipulate model behavior. Bias refers to systematic unfairness in outputs. In this case, the presence of fictional information in the generated report directly aligns with fabrication, making option B the correct answer.

NEW QUESTION 2

A colleague from another company shares a link to a prompt. When you select the link, you receive the following response: "Prompt not found. Sorry, it looks like the prompt is no longer available." What is a possible cause of the response?

- A. The prompt is a scheduled prompt.
- B. The prompt contains a reference to a file that you do NOT have access to.
- C. The prompt is outdated.
- D. The prompt contains a file that has a sensitivity label applied.
- E. The prompt is outside of your organization.

Answer: E

Explanation:

Microsoft 365 Copilot operates within the security, compliance, and identity boundaries of a Microsoft 365 tenant. Shared prompts, prompt links, and Copilot artifacts are governed by organizational access controls and tenant isolation. If a prompt is created and shared from outside your organization, cross-tenant access may not be supported depending on the sharing configuration and administrative policies. When a user attempts to open a prompt that resides in another organization's tenant without proper cross-tenant sharing permissions, Copilot cannot locate or validate the resource within the user's own environment. As a result, the system displays a "Prompt not found" message. Option B would typically result in an access or permissions error rather than the prompt being unavailable entirely. Sensitivity labels and scheduled prompts do not inherently cause a "not found" error. Therefore, the most likely cause is that the prompt exists outside your organization's tenant boundary and is not accessible to you.

=====

NEW QUESTION 3

You need to access Microsoft 365 Copilot from a web browser. Which URL should you use?

- A. <https://m365.cloud.microsoft>
- B. <https://copilotstudio.microsoft.com>
- C. <https://myapps.microsoft.com>
- D. <https://myaccountmicrosoft.com>

Answer: A

Explanation:

Microsoft 365 Copilot can be accessed via its dedicated web experience for enterprise users. The correct web entry point for Microsoft 365 Copilot is <https://m365.cloud.microsoft>, which provides authenticated access to Copilot features within the Microsoft 365 environment. This URL routes users into the Microsoft 365 ecosystem where Copilot integrates with organizational data such as SharePoint, OneDrive, Teams, and Outlook. It ensures that users are authenticated through Microsoft Entra ID and that access controls are enforced according to tenant policies. Option B refers to Copilot Studio, which is used to build and manage custom copilots and agents rather than access the Microsoft 365 Copilot chat experience. Option C (My Apps) is a general application launcher portal. Option D is an incorrect account management URL and does not provide Copilot access. Therefore, to access Microsoft 365 Copilot from a web browser, the correct URL is <https://m365.cloud.microsoft>.

NEW QUESTION 4

You use the Researcher agent in Microsoft 365 Copilot to generate a report. What can you use to verify whether the report was generated by using valid sources?

- A. citations
- B. instructions
- C. memory
- D. capabilities

Answer: A

Explanation:

The Researcher agent in Microsoft 365 Copilot is designed to gather and synthesize information from web and organizational sources. To support transparency

and trust, Copilot provides citations alongside generated content when external or referenced material is used. Citations allow users to review the original sources that informed the generated report. This aligns with Microsoft's Responsible AI commitment to transparency and verifiability. By selecting or reviewing citations, users can confirm that the information originates from credible and relevant references rather than unsupported model-generated text. Instructions define how the agent behaves but do not validate source authenticity. Memory refers to conversational context retention and does not confirm source validity. Capabilities describe what the agent can do, not whether its output is grounded in legitimate sources. Therefore, to verify that a report generated by the Researcher agent uses valid sources, you should review the citations.

NEW QUESTION 5

You use Microsoft 365 Copilot.
You regularly upload the same five files to Copilot chats.
You need to simplify referencing the files in the chats.
What are two ways to achieve the goal?

- A. Send a prompt that includes the files, and then save the prompt.
- B. Create a notebook that references the files.
- C. Ask the data engineers to create a fine-tuned model.
- D. Create an agent that has a knowledge source.
- E. Zip the documents and upload the ZIP file to the chats.

Answer: BD

Explanation:

Microsoft 365 Copilot provides structured ways to persist and reuse knowledge sources to avoid repeatedly uploading the same files. Creating a notebook that references the five files (Option B) allows those documents to remain attached within a persistent workspace. Copilot can then consistently ground responses in those files without re-uploading them for every conversation. Creating an agent with a defined knowledge source (Option D) also provides a reusable solution. By configuring the five files as part of the agent's knowledge base, the agent can automatically reference them in future interactions. Saving a prompt does not persist file attachments. Fine-tuning models is not part of standard Microsoft 365 Copilot user workflows. Uploading a ZIP file does not improve reference management and may reduce accessibility of individual documents. Therefore, the correct solutions are to create a notebook that references the files and to create an agent with a knowledge source.

NEW QUESTION 6

For each of the following statements, select Yes if the statement is true. Otherwise, select No. NOTE: Each correct selection is worth one point.

Answer Area

Statements	Yes	No
When you submit the same prompt to Microsoft 365 Copilot multiple times, and you are grounded in the web, the response will always be identical.	<input type="radio"/>	<input type="radio"/>
When you submit the same prompt to Microsoft 365 Copilot multiple times, and you are grounded in your own data, the response will always be identical.	<input type="radio"/>	<input type="radio"/>
When you submit the same prompt to Microsoft 365 Copilot multiple times, and you are grounded only in the model's knowledge, the response will always be identical.	<input type="radio"/>	<input type="radio"/>

- A. Mastered
- B. Not Mastered

Answer: A

Explanation:

All three statements are false because generative AI responses are not guaranteed to be identical even when the prompt is the same. First, when grounded in the web, results can vary due to changing web content, different retrieved sources, or differences in how information is summarized at run time. Second, when grounded in your organization's data, responses can change based on updates to files, emails, meetings, permissions, or which specific items Copilot retrieves as the most relevant context at that moment. Third, even when relying only on the model's general knowledge, large language models are probabilistic: they may choose different wording, structure, examples, or emphasis across runs, especially when temperature/decoding settings and internal routing differ. In business scenarios, this means Copilot outputs should be treated as drafts that may require validation, and repeatability should be improved by adding precise constraints (cite specific sources, use fixed formats, specify exact sections, and request verbatim quotes where appropriate).

NEW QUESTION 7

You plan to use a notebook in Microsoft 365 Copilot. What is the purpose of a notebook?

- A. to create a transcript of a conversation that you can easily email to other users
- B. to provide a private location that can be used to organize reference materials across related conversations
- C. to generate a summary of all the interactions you had with Copilot during a specific conversation

Answer: B

Explanation:

In Microsoft 365 Copilot, a Notebook is a focused, AI-powered workspace designed to organize reference materials for specific projects or topics. It acts as a curated container where you can bring together various resources--such as Word documents, PDFs, PowerPoint decks, meeting notes, and even previous Copilot

chats--into one location.

Reference:

<https://support.microsoft.com/en-us/topic/how-microsoft-365-copilot-notebooks-works-4071d73d-8bdd-478f-8968-8dc1d7c3d43e>

NEW QUESTION 8

You sign in to the Microsoft 365 Copilot app by using your work account as shown in the following exhibit

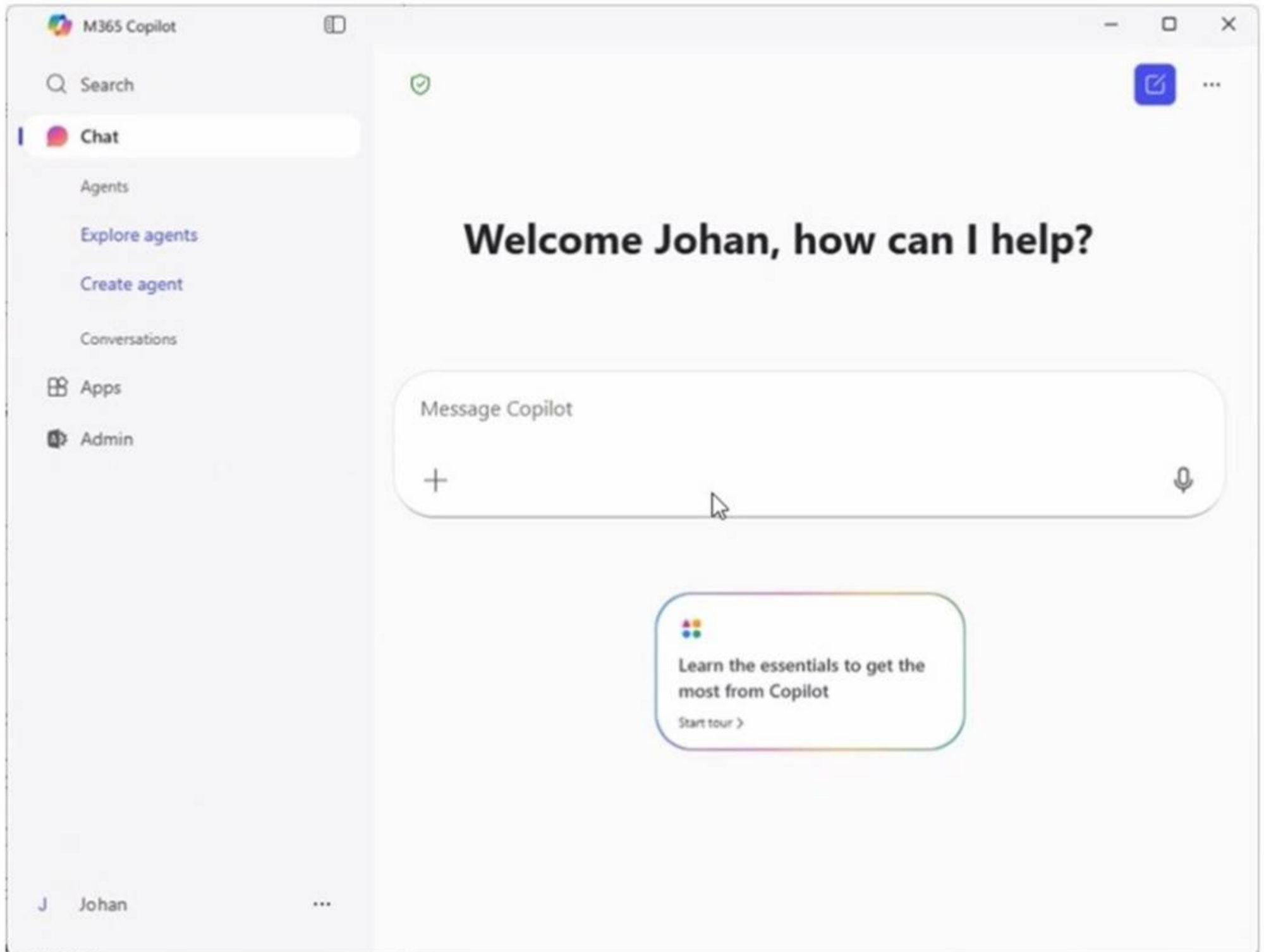

A colleague tells you that when they open the Microsoft 365 Copilot app, they have access to the Researcher agent. You need to access to the Researcher agent. What should you do?

- A. From Microsoft Edge, use your work account to sign in to <https://copilot.microsoft.com>.
- B. Select Explore agents and then search for Researcher.
- C. Sign in to the Copilot app by using a personal account
- D. Request a Microsoft 365 Copilot license from an administrator.

A.

Answer: B

NEW QUESTION 9

HOTSPOT

For each of the following statements, select Yes if the statement is true. Otherwise, select No. NOTE: Each correct selection is worth one point.

Answer Area

Statements	Yes	No
Prompt injection can cause data exposure and unintended system behavior.	<input type="radio"/>	<input type="radio"/>
Prompt injection can be used to embed malicious or harmful instructions.	<input type="radio"/>	<input type="radio"/>
Prompt injection is a security vulnerability unique to generative AI systems that interpret and respond to natural language inputs.	<input type="radio"/>	<input type="radio"/>

- A. Mastered
- B. Not Mastered

Answer: A

Explanation:

Prompt injection is a generative AI security risk where an attacker inserts instructions (often hidden in text, documents, webpages, or user inputs) to override or manipulate the assistant's intended behavior. This can lead to unintended actions such as ignoring policy controls, producing unsafe outputs, or attempting to reveal sensitive information. Because generative AI systems follow natural-language instructions, they can be socially engineered to prioritize malicious content unless safeguards are in place. This is why prompt injection can cause data exposure (for example, attempting to extract confidential content from grounded sources) and can also embed harmful instructions that redirect the model's behavior. In enterprise settings like Microsoft 365 Copilot, mitigations include grounding boundaries, permission trimming, content filtering, and instruction hierarchy (system policies over user instructions). From a business governance perspective, users should treat untrusted inputs (emails, documents, web text) as potentially hostile and apply least-privilege access and validation when using AI outputs in decision-making.

NEW QUESTION 10

You create a Microsoft 365 Copilot notebook and add a file named Process.docx from a local folder. Yesterday, you updated Process.docx in the local folder. What will occur when you chat in the notebook?

- A. The chat will reference both versions of Process.docx.
- B. The chat will reference the most recent version of Process.docx.
- C. The chat will reference only the original version of Process.docx.

A.

Answer: C

Explanation:

Microsoft 365 Copilot notebooks use the version of a file that was uploaded or attached at the time it was added to the notebook. When a document such as Process.docx is added from a local folder, Copilot references that uploaded snapshot of the file. If the file is later modified locally, the notebook does not automatically sync or refresh with the updated local version unless the updated file is re-uploaded.

Microsoft guidance on grounding and file references explains that Copilot works with the specific content stored in Microsoft 365 or the attached artifact within the notebook session. Since the updated version remains in the local folder and was not reattached, Copilot continues to use the originally added version.

Therefore, during subsequent chats in the notebook, Copilot references only the original uploaded version of Process.docx.

=====

NEW QUESTION 10

You are creating a custom analytics agent in the Microsoft 365 Copilot app. The agent will use Microsoft Excel files that contain sales data as knowledge.

You need to ensure that the agent can create visualizations, perform mathematical operations, create aggregations, and analyze the data in the files.

What should you add to the agent?

- A. code interpreter
- B. image generator
- C. a suggested prompt
- D. a template

A.

Answer: A

Explanation:

When building a custom analytics agent in Microsoft 365 Copilot that must process structured data from Excel files, advanced analytical capabilities are required. According to Microsoft AI Business Professional guidance, tasks such as performing mathematical calculations, generating aggregations, creating charts, and conducting structured data analysis require programmatic execution capabilities rather than simple text generation.

A code interpreter enables the agent to run Python-based analytical operations in a secure execution environment. This allows the agent to manipulate datasets, compute totals and averages, perform grouping and filtering, and generate visualizations such as bar charts or line graphs based on the Excel data. The interpreter bridges the gap between natural language instructions and executable analytical logic.

An image generator is designed for creative visual content and is unrelated to structured data analytics. Suggested prompts and templates improve usability and consistency but do not provide computational or visualization capabilities.

Therefore, to enable mathematical operations, aggregation, data analysis, and visualization of Excel sales data, the correct component to add to the agent is a code interpreter.

NEW QUESTION 13

You are discussing Microsoft 365 Copilot with a colleague. The colleague asks which data Copilot uses to answer questions when using the Work scope. What should you tell your colleague?

- A. Copilot provides responses based only on the general knowledge that Copilot was trained on.
- B. Copilot provides responses based on all the data in your organization's Microsoft 365 environment and the general knowledge that Copilot was trained on.
- C. Copilot provides responses based only on data that the user can access and the general knowledge that Copilot was trained on.
- D. Copilot provides responses based only on data that the user can access.

A.

Answer: C

Explanation:

Microsoft 365 Copilot operates within two primary knowledge boundaries: its foundational large language model training data and the organizational data available within the Microsoft 365 tenant. However, Copilot strictly enforces Microsoft's security and compliance model, meaning it only retrieves and uses data that the signed-in user is authorized to access.

When using the Work scope, Copilot combines the general knowledge it was trained on with organizational data such as documents, emails, chats, calendars, and files stored in Microsoft 365. Importantly, Copilot respects role-based access control and existing permissions. It does not surface information from content the user does not have access to.

Option A is incomplete because Work scope includes organizational data. Option B is incorrect because Copilot does not access all tenant data indiscriminately; it is permission-scoped. Option D is incomplete because Copilot also leverages its general training knowledge.

Therefore, the correct explanation is that Copilot provides responses based only on data the user can access, combined with its general training knowledge.

NEW QUESTION 17

You use Microsoft 365 Copilot to create a proposal in Microsoft Word based on a document in a Microsoft SharePoint library. You need to ensure that the information cited in the proposal is accurate. What is the best approach to achieve the goal? More than one answer choice may achieve the goal. Select the BEST answer.

- A. Manually verify the citations in the generated content.
- B. Use Copilot in Word to verify the citations.
- C. Create an agent that contains your organization's editorial standards and use the agent to verify the citations.
- D. Create a notebook that contains all the reference material and use the notebook to verify the citations.

Answer: A

NEW QUESTION 21

You create a Microsoft 365 Copilot notebook and add a file named Process.docx from a Microsoft SharePoint site as a reference. Yesterday, a user updated Process.docx in the SharePoint site. What will occur when you chat in the notebook?

- A. The chat will reference only the original version of Process.docx.
- B. The chat will reference the most recent version of Process.docx.
- C. The chat will reference both versions of Process.docx.

Answer: B

NEW QUESTION 23

HOTSPOT

Select the answer that correctly completes the sentence.

Answer Area



A screenshot of a dropdown menu. The menu is open, showing four options: Microsoft Defender for Cloud, Microsoft Entra ID, Microsoft Intune, and Microsoft Purview. The text "Microsoft Purview" is highlighted with a dashed green border.

enables organizations to apply governance policies to conversations generated by using Microsoft 365 Copilot.

- A. Mastered
- B. Not Mastered

Answer: A

Explanation:

Answer Area

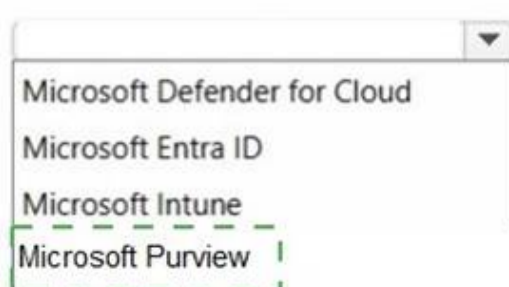

A screenshot of a dropdown menu, identical to the one above. The text "Microsoft Purview" is highlighted with a dashed green border.

enables organizations to apply governance policies to conversations generated by using Microsoft 365 Copilot.

NEW QUESTION 25

HOTSPOT

You have a Microsoft 365 subscription.

You do NOT have a Microsoft 365 Copilot license.

For each of the following statements, select Yes if the statement is true. Otherwise, select No.

NOTE: Each correct selection is worth one point.

Answer Area

Statements

Microsoft 365 Copilot Chat lets you upload documents from your local computer.

Yes

No

Microsoft 365 Copilot Chat is included with Microsoft 365 Business Standard.

Microsoft 365 Copilot Chat lets you create and use agents that can access Microsoft SharePoint folders.

- A. Mastered
- B. Not Mastered

Answer: A

Explanation:

Answer Area

Statements

Microsoft 365 Copilot Chat lets you upload documents from your local computer.

Yes

No

Microsoft 365 Copilot Chat is included with Microsoft 365 Business Standard.

Microsoft 365 Copilot Chat lets you create and use agents that can access Microsoft SharePoint folders.

NEW QUESTION 28

.....

Thank You for Trying Our Product

* 100% Pass or Money Back

All our products come with a 90-day Money Back Guarantee.

* One year free update

You can enjoy free update one year. 24x7 online support.

* Trusted by Millions

We currently serve more than 30,000,000 customers.

* Shop Securely

All transactions are protected by VeriSign!

100% Pass Your AB-730 Exam with Our Prep Materials Via below:

<https://www.certleader.com/AB-730-dumps.html>